

County Route 50 - Site Plan 33+50 to 48+50  
SCALE: 1" = 40'

**Legend**

- - - - - EXISTING 2' CONTOUR
- - - - - EXISTING 10' CONTOUR
- - - - - EXISTING HIGHWAY BOUNDS
- - - - - UTILITY POLE AND OVERHEAD WIRES
- - - - - EXISTING STONEWALL
- - - - - WETLANDS BOUNDARY WITH IDENTIFICATION FLAG
- - - - - EXISTING WOOD FENCE

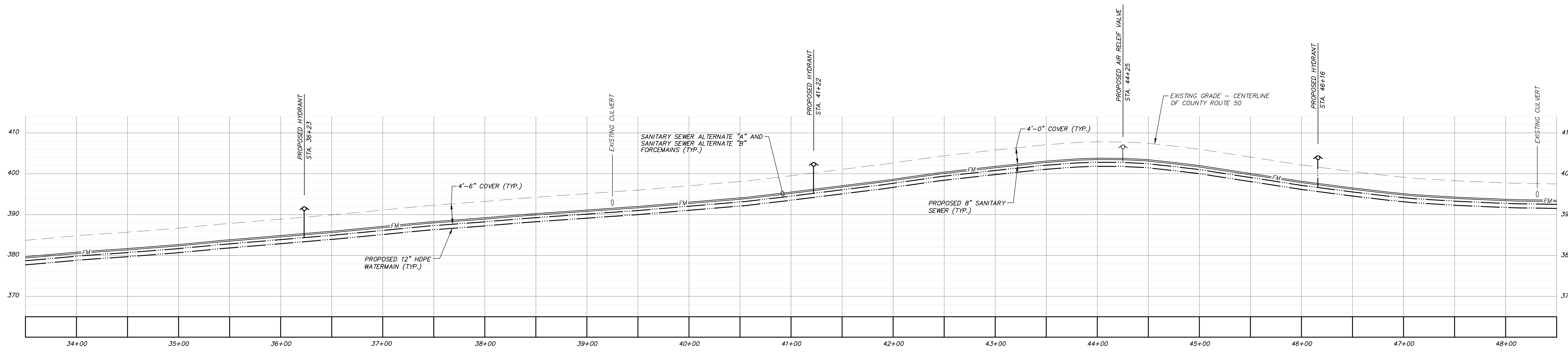

County Route 50 - Centerline Profile 33+50 to 54+00  
SCALE: HORIZONTAL 1" = 40'  
VERTICAL 1" = 4'

**NOTES**

1. PRIOR TO FINAL DESIGN, AN UNDERGROUND SURVEY OF THE GAS MAIN ON THE SOUTH SIDE OF COUNTY ROUTE 50 SHALL BE UNDERTAKEN.
2. UNDERGROUND UTILITIES SHOWN ON THIS PLAN WERE DERIVED FROM EXISTING MAPPING AND DO NOT REFLECT THE RESULTS OF ACTUAL FIELD SURVEY. THIS PLAN IS FOR REVIEW PURPOSES ONLY AND NOT INTENDED FOR UNDERGROUND INVESTIGATIONS SUCH AS BORINGS / TEST PITS, OR CONSTRUCTION.
3. WATER HYDRANT LOCATIONS TO BE DETERMINED AFTER MARKOUT OF EXISTING GAS MAIN.
4. THESE PLANS PREVENT TWO ALTERNATES FOR WASTEWATER DISPOSAL: ALTERNATE A: A PRIVATE PUMP STATION OWNED AND MAINTAINED BY THE PROJECT SPONSOR WILL TRANSMIT WASTEWATER FROM THE PROJECT VIA FORCE MAIN TO THE TOWN OF WALKILL COLLECTION SYSTEM. ALTERNATE B: THE PROJECT SPONSOR WILL CONSTRUCT A GRAVITY SEWER ON COUNTY ROUTE 50 TO THE MONNEGAN BROOK. WASTEWATER WILL BE TRANSMITTED VIA FORCE MAIN TO THE TOWN OF WALKILL COLLECTION SYSTEM. UPON COMPLETION, AN ORDER OF DEDICATION WILL BE MADE TO THE TOWN OF WAWAYANDA, TO FACILITATE CREATION OF A TOWN SEWER DISTRICT.
5. WASTE SYSTEM IMPROVEMENTS SHOWN ON THESE PLANS SHALL BE CONSTRUCTION BY THE PROJECT SPONSOR AND AN OFFER OF DEDICATION MADE TO THE TOWN OF WAWAYANDA.

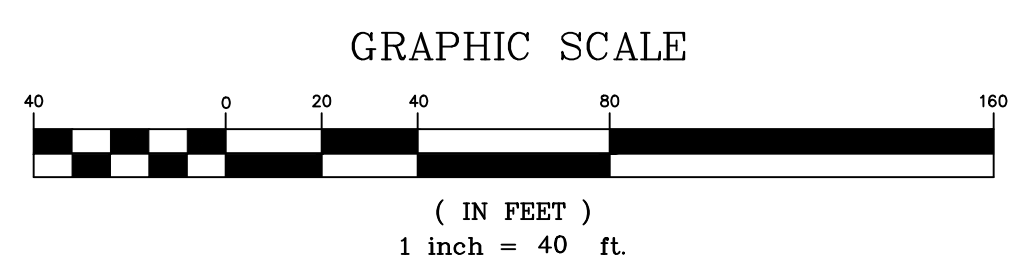

**NOTE:**  
THE PLANS AND DETAILS CONTAINED IN THIS SET ARE THE PROPERTY OF ALPINE ENVIRONMENTAL CONSULTANTS AND ARE TO BE USED ONLY FOR THE PROJECT AND SITE SPECIFICALLY IDENTIFIED HEREIN. NO PART OF THIS SET IS TO BE REPRODUCED, COPIED, OR TRANSMITTED IN ANY FORM OR BY ANY MEANS, WITHOUT THE WRITTEN PERMISSION OF ALPINE ENVIRONMENTAL CONSULTANTS. ANY UNAUTHORIZED REPRODUCTION OR USE OF THIS SET SHALL BE CONSIDERED A VIOLATION OF THE PROFESSIONAL ENGINEER'S SEAL AND IS A VIOLATION OF SECTION 7209, SUB-DIVISION 2 OF THE N.Y. STATE EDUCATION LAW.

DATE	DESCRIPTION
2/2/13	PRELIMINARY PLANS

**KENT FARM**  
SECT. 1, BLOCK 1, LOT 38.1  
TOWN OF WAWAYANDA  
ORANGE COUNTY, NEW YORK

County Route 50  
Plan & Profile - Section 3

P.O. BOX 145  
MONTGOMERY, NEW YORK 12549

**JOHN PETROCCIONE P.E.**  
LICENSE NO. 078516  
129 NEPTUNE DRIVE, MONROE, NEW YORK 10950  
(845) 782-7725

SCALE	PROJECT	CAD REFERENCE
1" = 40'	0996	E7-SECTION 3.DWG
NYSDEC DWG.NO	OCHD DWG.NO	DWG.NO
N/A of N/A	N/A of N/A	E7

UNAUTHORIZED ALTERATION OF ADDITION TO A PLAN BEARING A LICENSED LAND SURVEYOR'S OR PROFESSIONAL ENGINEER'S SEAL IS A VIOLATION OF SECTION 7209, SUB-DIVISION 2 OF THE N.Y. STATE EDUCATION LAW.